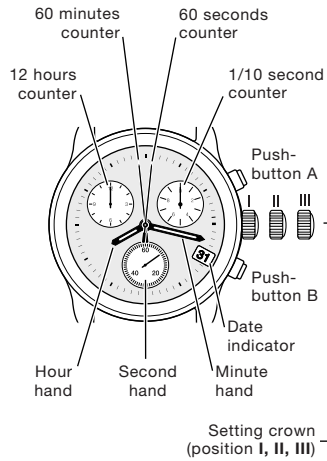
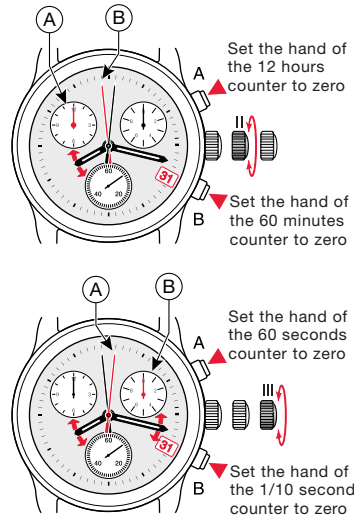
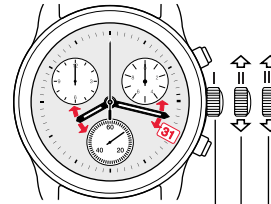

DISPLAY**Watch hands****A****SETTING THE COUNTERS TO ZERO****Setting crown in position II or III****B****SETTINGS****Crown 3 positions**

Normal running of watch

Correcting time-zone and correction of the date at every passing to midnight

Correcting time position: stop second and correction of the date at every passing to midnight

Note :
Dietting crown in position II for longer 20 minutes (time could be lost).

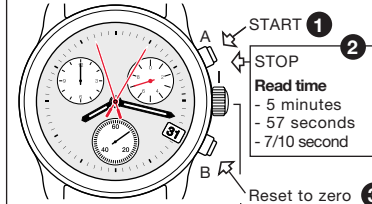
C**TIMING MODE****Simple timing function**

START 1

STOP 2

Read time
- 5 minutes
- 57 seconds
- 7/10 second

Reset to zero 3

Setting crown in position I

1 to 3 order of functions

WARNING
Before starting the time, put back the chronograph hands to their original position. If necessary, see paragraph SETTING THE COUNTERS TO ZERO.

D

CHRONOGRAPH

ETA 251.232

Eta Swiss Quartz

400 984 - 29.03.2004 / ETA / 00

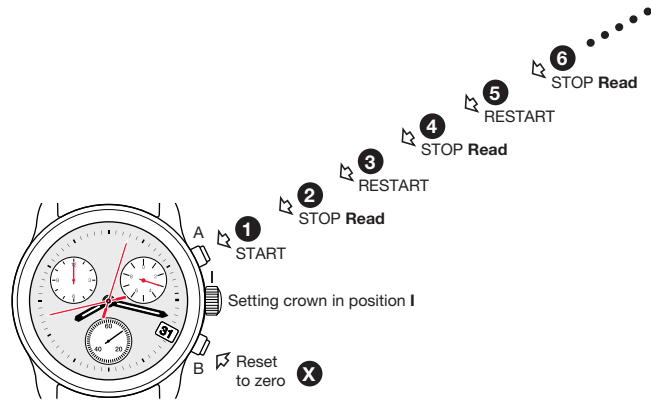
TIMING MODE**ADD function**

1 to X order of functions

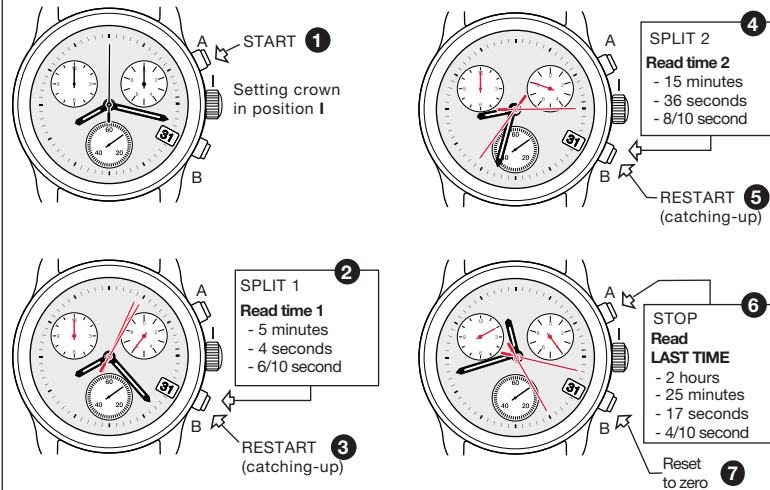
E**TIMING MODE****SPLIT-TIME or INTERMEDIATE TIME function**

1 to 7 order of functions

F